

HPP22-工程塑料轴承 Plastic Plain Bearings

轴承PV值 PV Value

HPP22塑料轴承最大运行PV值为 $0.45\text{N/mm}^2 \times \text{m/s}$;由此决定轴承所承受的载荷与速度成反比, 详情查阅图表HPP22-1。

The max PV value of the HPP22 plastic bearing is $0.45\text{N/mm}^2 \times \text{m/s}$ which determines the load capacity of bearing is inversely proportional to the speed. Please refer to the chart for more detailed information (Graph HPP22-1).

图表 HPP22-1: PV 图表

Graph HPP22-1: Permissible PV value for HPP22

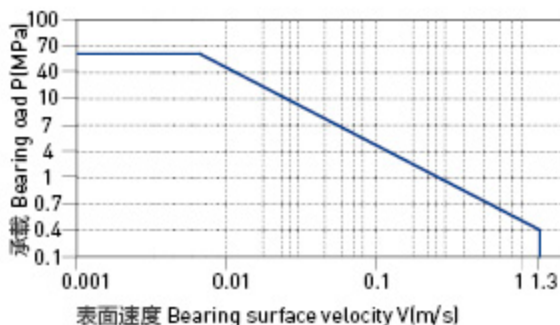

轴承的载荷、速度、温度 The Relation Of Load, Speed And Temperature

HPP22系列轴承可承受最大静载荷为60Mpa, 在此载荷下轴承的最大压缩变形量参考图表HPP22-2, 轴承实际工作载荷略小于60Mpa, 载荷还受到运行速度以及温度的影响, 速度越快(Vmax: 1.3m/s)会导致摩擦温度上升, 而温度上升(Tmax: 180℃)会导致轴承的承载能力逐渐减弱, 载荷随轴承工作温度变化情况参考图表HPP22-3。

Graph HPP22-4 shows that the friction factor of HPP22 is not sensitive to the operation speed and Graph HPP22-5 shows that the friction factor is HPP22 is decreased along with the loading increasing and become stable when the loading is over 20Mpa. Graph HPP22-6 tells that the friction factor of HPP22 is also not sensitive to the shaft roughness but we still recommend the shaft roughness to be Ra0.7~0.9.

图表 HPP22-2: 载荷 - 温度 - 变形量图表

Graph HPP22-2: Load-Temperature deformation

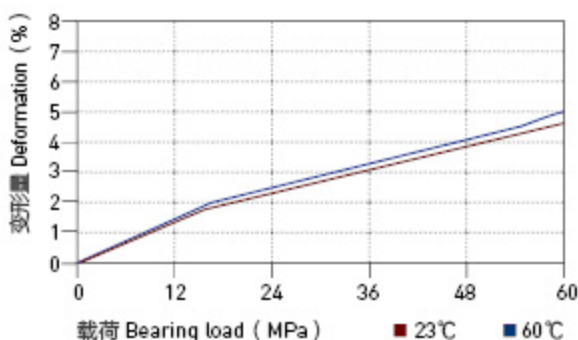

图表 HPP22-3: 载荷 - 温度图表

Graph HPP22-3: Load-Temperature diagrams

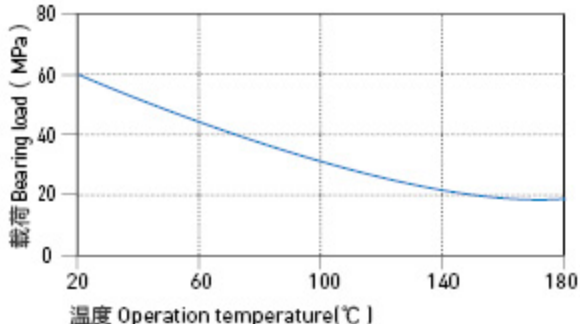

HPP22-工程塑料轴承 Plastic Plain Bearings

轴承的摩擦系数、磨损、轴材料 Friction Factor, Wear And Shaft Material

■ 轴承的摩擦系数 Friction factor

图表HPP22-4表明HPP22轴承的摩擦系数随着运动速度的变化影响较小，而图表HPP22-5表明HPP22轴承的摩擦系数随着载荷的增加明显减小，在载荷超过20Mpa是逐渐趋于平稳；图表HPP22-6表明HPP22轴承的摩擦系数受轴粗糙度的影响也相对比较小；虽然如此，我们还是建议轴的表面不能太光滑，也不能过于出差，推荐使用轴的粗糙度为Ra0.7~0.9 μ m；

Graph HPP22-4 shows that the friction factor of HPP22 is not sensitive to the operation speed and Graph HPP22-5 shows that the friction factor is HPP22 is decreased along with the loading increasing and become stable when the loading is over 20Mpa. Graph HPP22-6 tells that the friction factor of HPP22 is also not sensitive to the shaft roughness but we still recommend the shaft roughness to be Ra0.7~0.9.

HPP22	干运行 Dry	油脂 Grease	油 Oil	水 Water
摩擦系数 μ Friction coef.	0.05~0.15	0.09	0.04	0.04

■ 磨损与轴材料 Wearing and shaft material

图表HPP22-7表明HPP22轴承在2Mpa下做旋转运动时，磨损随着轴材料的变化较大；通过实验表明HPP22轴承在做旋转运动时比较适合用于硬轴，高速钢轴和硬铬轴上用于HPP22能获得良好的运行效果。图表HPP22-8表明硬铬轴更适合用于高载荷下的HPP22轴承，随着载荷的不断增加，轴承的磨损速率却变化较小。

Graph HPP22-7 shows that the wearing of HPP22 is sensitive to different materials under rotation operation with the loading of 2Mpa. It is suitable for hardened shaft, high speed steel shaft and hardened chrome steel shaft in the rotation operation. Hardened chrome steel shaft is the best choice for HPP22 (Graph HPP22-8). The wearing will be decreased as long as the loading increasing.

图表 HPP22-4: 摩擦系数与速度变化关系图表 P=2MPa

Graph HPP22-4: Coefficient of friction & the speed of bearing, P=2Mpa

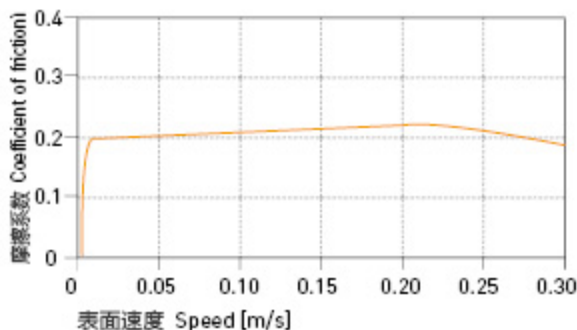

图表 HPP22-5: 摩擦系数与载荷变化关系图表 v=0.2m/s

Graph HPP22-5: Coefficient of friction & the pressure of bearing, v=0.2m/s

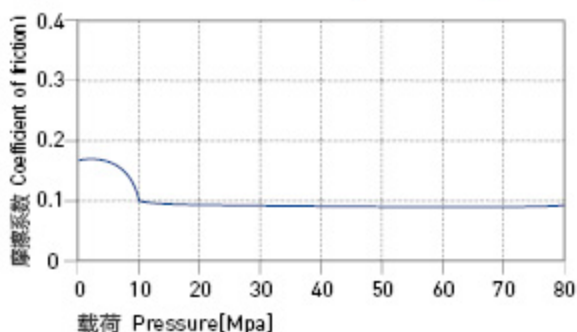

图表 HPP22-6: 摩擦系数与轴表面粗糙度关系图表

Graph HPP22-6: Coefficient of friction & the surface roughness of shaft

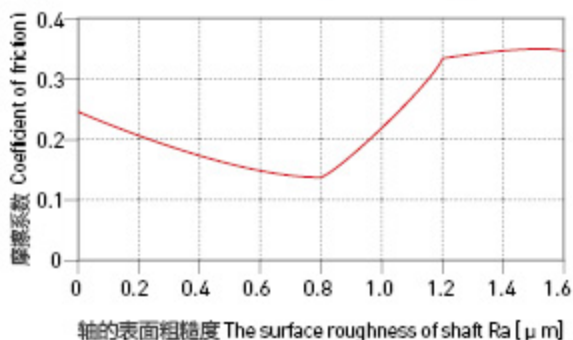

HPP22-工程塑料轴承 Plastic Plain Bearings

轴承的摩擦系数、磨损、轴材料 Friction Factor, Wear And Shaft Material

■ 化学抗性 Chemical Resistance

HPP22塑料轴承能抵抗弱碱以及各类润滑油的腐蚀。

HPP22 is good at chemical resistance against weak acidic medium and various kinds of lubricants.

■ 吸水性 Water Absorbability

在标准大气压中，HPP22塑料轴承的吸水率为0.3%，浸泡水中最大平衡吸水率为1.6%；由于此吸水率的特性，我们必须考虑此轴承的应用环境。

The water absorb rate of HPP22 is 0.3% under the atmospheric pressure while it is 1.6% when the material is immersed into water. The application environment has to be considered because of its water absorb properties.

■ 抗UV性能 UV Resistance

HPP22长久暴露在紫外线下颜色基本不会改变。材料性能基本都不会发生改变。

HPP22 can maintain its color unchanged when it is exposed into the UV ray. The material performance stays stable.

■ 安装公差 Installation Tolerances

HPP22塑料轴承压装后公差Tolerances after pressfit

直径 DI. [mm]	HPP22 E10 [mm]	座孔 Housing H7 [mm]	轴 Shaft h9 [mm]
> 0-3	+0.014~+0.054	0~+0.010	0~-0.025
> 3-6	+0.020~+0.068	0~+0.012	0~-0.030
> 6-10	+0.025~+0.083	0~+0.015	0~-0.036
> 10-18	+0.032~+0.102	0~+0.018	0~-0.043
> 18-30	+0.040~+0.124	0~+0.021	0~-0.052
> 30-50	+0.050~+0.150	0~+0.025	0~-0.062
> 50-80	+0.060~+0.180	0~+0.030	0~-0.074
> 80-120	+0.072~+0.212	0~+0.035	0~-0.087
> 120-180	+0.085~+0.245	0~+0.040	0~-0.100

图表 HPP22-7: 在不同轴材料上旋转时的磨损量 $P=2\text{MPa}$, $v=0.2\text{m/s}$
Graph HPP22-7: The bearing wear under rotating with different shaft materials, $p=2\text{MPa}$, $v=0.2\text{m/s}$

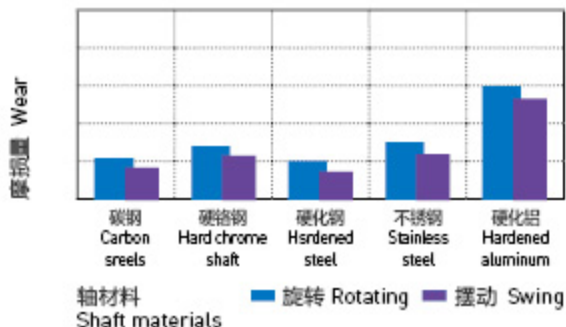

图表 HPP22-8: 旋转磨损随轴材料与压力变化关系 $v=0.2\text{m/s}$
Graph HPP22-8: The bearing wear & pressure under rotating with different shaft materials, $v=0.2\text{m/s}$

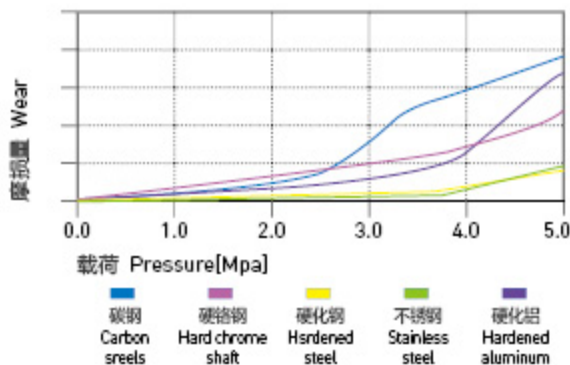

图表 HPP22-9: 吸水性的影响

Graph HPP22-9: Effect of moisture absorption on HPP22 bearings

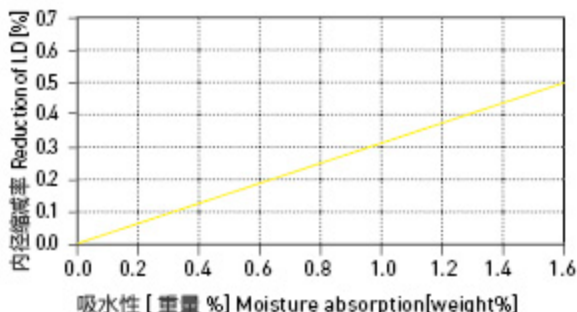

HPP22标准规格Standard 直套Metric Cylindrical Bushings

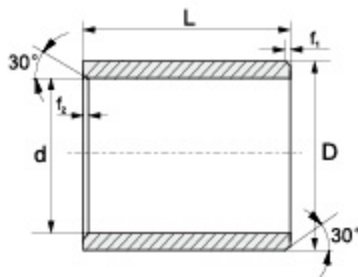

推荐安装公差 Recommend fitting tolerance:

座孔 Housing: H7

轴 Shaft: h9

订购编码 Order P/N:

HPP22-0203-03

材料 Material

d	f ₁	f ₂
1-6	0.3	0.5
6-12	0.5	
12-30	0.8	
>30	1.2	

订购编码 Order PN	d [mm]	d-公差 After fitting [mm]	D [mm]	L(h13) [mm]
HPP22-0203-03	2	+0.014/+0.054	3.5	3
HPP22-0304-03	3	+0.014/+0.054	4.5	3
HPP22-0304-05	3	+0.014/+0.054	4.5	5
HPP22-0304-06	3	+0.014/+0.054	4.5	6
HPP22-0405-04	4	+0.02/+0.068	5.5	4
HPP22-0405-06	4	+0.02/+0.068	5.5	6
HPP22-0506-05S	5	+0.01/+0.04	6	5
HPP22-0507-05	5	+0.02/+0.068	7	5
HPP22-0507-08	5	+0.02/+0.068	7	8
HPP22-0507-10	5	+0.02/+0.068	7	10
HPP22-0608-04	6	+0.02/+0.068	8	4
HPP22-0608-05	6	+0.02/+0.068	8	5
HPP22-0608-06	6	+0.02/+0.068	8	6
HPP22-0608-08	6	+0.02/+0.068	8	8
HPP22-0608-09	6	+0.02/+0.068	8	9
HPP22-0608-10	6	+0.02/+0.068	8	10
HPP22-0608-11	6	+0.02/+0.068	8	11
HPP22-0810-05	8	+0.025/+0.083	10	5
HPP22-0810-06	8	+0.025/+0.083	10	6
HPP22-0810-07	8	+0.025/+0.083	10	7
HPP22-0810-08	8	+0.025/+0.083	10	8
HPP22-0810-10	8	+0.025/+0.083	10	10
HPP22-0810-12	8	+0.025/+0.083	10	12
HPP22-0810-13	8	+0.025/+0.083	10	13
HPP22-0810-15	8	+0.025/+0.083	10	15
HPP22-0810-21	8	+0.025/+0.083	10	21
HPP22-1011-06	10	+0.025/+0.083	11	6
HPP22-1012-04	10	+0.025/+0.083	12	4
HPP22-1012-05	10	+0.025/+0.083	12	5
HPP22-1012-06	10	+0.025/+0.083	12	6
HPP22-1012-07	10	+0.025/+0.083	12	7
HPP22-1012-08	10	+0.025/+0.083	12	8
HPP22-1012-09	10	+0.025/+0.083	12	9
HPP22-1012-10	10	+0.025/+0.083	12	10
HPP22-1012-12	10	+0.025/+0.083	12	12
HPP22-1012-14	10	+0.025/+0.083	12	14

订购编码 Order PN	d [mm]	d-公差 After fitting [mm]	D [mm]	L(h13) [mm]
HPP22-1012-15	10	+0.025/+0.083	12	15
HPP22-1012-17	10	+0.025/+0.083	12	17
HPP22-1012-20	10	+0.025/+0.083	12	20
HPP22-1213-12S	12	+0.016/+0.059	13	12
HPP22-1214-04	12	+0.032/+0.102	14	4
HPP22-1214-06	12	+0.032/+0.102	14	6
HPP22-1214-08	12	+0.032/+0.102	14	8
HPP22-1214-10	12	+0.032/+0.102	14	10
HPP22-1214-12	12	+0.032/+0.102	14	12
HPP22-1214-14	12	+0.032/+0.102	14	14
HPP22-1214-15	12	+0.032/+0.102	14	15
HPP22-1214-20	12	+0.032/+0.102	14	20
HPP22-1214-25	12	+0.032/+0.102	14	25
HPP22-1315-15	13	+0.032/+0.102	15	15
HPP22-1315-25	13	+0.032/+0.102	15	25
HPP22-1416-03	14	+0.032/+0.102	16	3
HPP22-1416-08	14	+0.032/+0.102	16	8
HPP22-1416-10	14	+0.032/+0.102	16	10
HPP22-1416-15	14	+0.032/+0.102	16	15
HPP22-1416-20	14	+0.032/+0.102	16	20
HPP22-1416-25	14	+0.032/+0.102	16	25
HPP22-1517-10	15	+0.032/+0.102	17	10
HPP22-1517-12	15	+0.032/+0.102	17	12
HPP22-1517-15	15	+0.032/+0.102	17	15
HPP22-1517-20	15	+0.032/+0.102	17	20
HPP22-1517-25	15	+0.032/+0.102	17	25
HPP22-1618-10	16	+0.032/+0.102	18	10
HPP22-1618-12	16	+0.032/+0.102	18	12
HPP22-1618-15	16	+0.032/+0.102	18	is
HPP22-1618-20	16	+0.032/+0.102	18	20
HPP22-1618-25	16	+0.032/+0.102	18	25
HPP22-1618-30	16	+0.032/+0.102	18	30
HPP22-1820-10	18	+0.032/+0.102	20	10
HPP22-1820-12	18	+0.032/+0.102	20	12
HPP22-1820-15	18	+0.032/+0.102	20	15
HPP22-1820-20	18	+0.0321+0.102	20	20

订购编码 Order PN	d [mm]	d- 公差 After fitting [mm]	D [mm]	L(h13) [mm]
HPP22-1820-25	18	+0.032/+0.102	20	25
HPP22-2022-20	20	+0.04/+0.124	22	20
HPP22-2022-30	20	+0.04/+0.124	22	30
HPP22-2023-10	20	+0.04/+0.124	23	10
HPP22-2023-15	20	+0.04/+0.124	23	15
HPP22-2023-20	20	+0.04/+0.124	23	20
HPP22-2023-25	20	+0.04/+0.124	23	25
HPP22-2023-30	20	+0.04/+0.124	23	30
HPP22-2225-15	22	+0.04/+0.124	25	15
HPP22-2225-20	22	+0.04/+0.124	25	20
HPP22-2225-25	22	+0.04/+0.124	25	25
HPP22-2225-30	22	+0.04/+0.124	25	30
HPP22-2528-12	25	+0.04/+0.124	28	12
HPP22-2528-15	25	+0.04/+0.124	28	15
HPP22-2528-20	25	+0.04/+0.124	28	20
HPP22-2528-24	25	+0.04/+0.124	28	24
HPP22-2528-25	25	+0.04/+0.124	28	25
HPP22-2528-30	25	+0.04/+0.124	28	30
HPP22-2528-35	25	+0.04/+0.124	28	35
HPP22-2832-30	28	+0.04/+0.124	32	30
HPP22-3034-15	30	+0.04/+0.124	34	15
HPP22-3034-20	30	+0.04/+0.124	34	20
HPP22-3034-24	30	+0.04/+0.124	34	24
HPP22-3034-25	30	+0.04/+0.124	34	25
HPP22-3034-30	30	+0.04/+0.124	34	30
HPP22-3034-35	30	+0.04/+0.124	34	35
HPP22-3034-40	30	+0.04/+0.124	34	40
HPP22-3236-30	32	+0.05/+0.15	36	30
HPP22-3236-40	32	+0.05/+0.15	36	40
HPP22-3539-14	35	+0.05/+0.15	39	14
HPP22-3539-20	35	+0.05/+0.15	39	20
HPP22-3539-25	35	+0.05/+0.15	39	25
HPP22-3539-30	35	+0.05/+0.15	39	30

订购编码 Order PN	d [mm]	d- 公差 After fitting [mm]	D [mm]	L(h13) [mm]
HPP22-3539-40	35	+0.05/+0.15	39	40
HPP22-3539-50	35	+0.05/+0.15	39	50
HPP22-3640-20	36	+0.05/+0.15	40	20
HPP22-4044-10	40	+0.05/+0.15	44	10
HPP22-4044-16	40	+0.05/+0.15	44	16
HPP22-4044-20	40	+0.05/+0.15	44	20
HPP22-4044-30	40	+0.05/+0.15	44	30
HPP22-4044-40	40	+0.05/+0.15	44	40
HPP22-4044-50	40	+0.05/+0.15	44	50
HPP22-4246-40	42	+0.05/+0.15	46	40
HPP22-4246-50	42	+0.05/+0.15	46	50
HPP22-4550-40	45	+0.05/+0.15	50	40
HPP22-4550-50	45	+0.05/+0.15	50	50
HPP22-5055-20	50	+0.05/+0.15	55	20
HPP22-5055-30	50	+0.05/+0.15	55	30
HPP22-5055-40	50	+0.05/+0.15	55	40
HPP22-5055-50	50	+0.05/+0.15	55	50
HPP22-5560-20	55	+0.06/+0.18	60	20
HPP22-5560-26	55	+0.06/+0.18	60	26
HPP22-5560-40	55	+0.06/+0.18	60	40
HPP22-5560-50	55	+0.06/+0.18	60	50
HPP22-5560-60	55	+0.06/+0.18	60	60
HPP22-6065-30	60	+0.06/+0.18	65	30
HPP22-6065-40	60	+0.06/+0.18	65	40
HPP22-6065-50	60	+0.06/+0.18	65	50
HPP22-6065-60	60	+0.06/+0.18	65	60
HPP22-6570-50	65	+0.06/+0.18	70	50
HPP22-7075-60	70	+0.06/+0.18	75	60
HPP22-7580-40	75	+0.06/+0.18	80	40
HPP22-115121-90	115	+0.072/+0.212	121	90
HPP22-120125-100	120	+0.072/+0.212	125	100

*d 公差为压入标准 H7 座孔 (ISO3547-1) 后公差

*Tolerance d: after being pressed into housing H7(ISO3547-1)

翻边轴套 Metric Flange Bushings

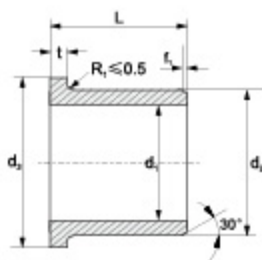

推荐安装公差 Recommend fitting tolerance:

座孔 Housing: H7

轴 Shaft: h9

订购编码 Order P/N:

HPP22 F-0304-03

材料 Material
 翻边轴套 Flange bushes
 d₁ d₂ L

d	f
1-6	0.3
6-12	0.5
12-30	0.8
>30	1.2

订购编码 Order PN	d ₁ [mm]	d ₁ -公差 After fitting [mm]	d ₂ [mm]	d ₂ [d13] [mm]	L[h13] [mm]	t _{0.15} [mm]
HPP22F-0304-03	3	+0.014/+0.054	4.5	7.5	3	0.75
HPP22F-0304-05	3	+0.014/+0.054	4.5	7.5	5	0.75
HPP22F-0405-03	4	+0.02/+0.068	5.5	9.5	3	0.75
HPP22F-0405-04	4	+0.02/+0.068	5.5	9.5	4	0.75
HPP22F-0405-06	4	+0.02/+0.068	5.5	9.5	6	0.75
HPP22F-0506-3.5S	5	+0.01/+0.04	6	10	3.5	0.5
HPP22F-0506-05S	5	+0.01/+0.04	6	10	5	0.5
HPP22F-050614-06S	5	+0.01/+0.04	6	14	6	0.5
HPP22F-0507-03	5	+0.02/+0.068	7	11	3	1
HPP22F-0507-04	5	+0.02/+0.068	7	11	4	1
HPP22F-0507-05	5	+0.02/+0.068	7	11	5	1
HPP22F-0507-07	5	+0.02/+0.068	7	11	7	1
HPP22F-0607-10	6	+0.01/+0.04	7	11	10	0.5
HPP22F-0608-04	6	+0.02/+0.068	8	12	4	1
HPP22F-0608-05	6	+0.02/+0.068	8	12	5	1
HPP22F-0608-06	6	+0.02/+0.068	8	12	6	1
HPP22F-0608-07	6	+0.02/+0.068	8	12	7	1
HPP22F-0608-08	6	+0.02/+0.068	8	12	8	1
HPP22F-0608-10	6	+0.02/+0.068	8	12	10	1
HPP22F-0708-08S	7	+0.013/+0.049	8	12	8	0.5
HPP22F-0809-12	8	+0.013/+0.049	9	13	12	0.5
HPP22F-0810-04	8	+0.025/+0.083	10	15	4	1
HPP22F-0810-05	8	+0.025/+0.083	10	15	5	1
HPP22F-0810-07	8	+0.025/+0.083	10	15	7	1
HPP22F-0810-09	8	+0.025/+0.083	10	15	9	1
HPP22F-0810-10	8	+0.025/+0.083	10	15	10	1
HPP22F-0810-15	8	+0.025/+0.083	10	15	15	1
HPP22F-0810-30	8	+0.025/+0.083	10	15	30	1
HPP22F-1012-04	10	+0.025/+0.083	12	18	4	1
HPP22F-1012-05	10	+0.025/+0.083	12	18	5	1
HPP22F-1012-06	10	+0.025/+0.083	12	18	6	1
HPP22F-1012-07	10	+0.025/+0.083	12	18	7	1
HPP22F-1012-09	10	+0.025/+0.083	12	18	9	1
HPP22F-1012-10	10	+0.025/+0.083	12	18	10	1
HPP22F-1012-12	10	+0.025/+0.083	12	18	12	1
HPP22F-1012-15	10	+0.025/+0.083	12	18	15	1
HPP22F-1012-17	10	+0.025/+0.083	12	18	17	1
HPP22F-101216-06	10	+0.025/+0.083	12	16	6	1
HPP22F-101216-09	10	+0.025/+0.083	12	16	9	1
HPP22F-1213-12S	12	+0.016/+0.059	13	17	12	0.5
HPP22F-1214-06	12	+0.032/+0.102	14	20	6	1
HPP22F-1214-07	12	+0.032/+0.102	14	20	7	1
HPP22F-1214-09	12	+0.032/+0.102	14	20	9	1
HPP22F-1214-10	12	+0.032/+0.102	14	20	10	1
HPP22F-1214-11	12	+0.032/+0.102	14	20	11	1
HPP22F-1214-12	12	+0.032/+0.102	14	20	12	1
HPP22F-1214-15	12	+0.032/+0.102	14	20	15	1

订购编码 Order PN	d ₁ [mm]	d ₁ -公差 After fitting [mm]	d ₂ [mm]	d ₂ [d13] [mm]	L[h13] [mm]	t _{0.15} [mm]
HPP22F-1214-17	12	+0.032/+0.102	14	20	17	1
HPP22F-1214-20	12	+0.032/+0.102	14	20	20	1
HPP22F-1214-24	12	+0.032/+0.102	14	20	24	1
HPP22F-1416-03	14	+0.032/+0.102	16	22	3	1
HPP22F-1416-04	14	+0.032/+0.102	16	22	4	1
HPP22F-1416-06	14	+0.032/+0.102	16	22	6	1
HPP22F-1416-08	14	+0.032/+0.102	16	22	8	1
HPP22F-1416-12	14	+0.032/+0.102	16	22	12	1
HPP22F-1416-17	14	+0.032/+0.102	16	22	17	1
HPP22F-1416-21	14	+0.032/+0.102	16	22	21	1
HPP22F-1517-05	15	+0.032/+0.102	17	23	5	1
HPP22F-1517-09	15	+0.032/+0.102	17	23	9	1
HPP22F-1517-12	15	+0.032/+0.102	17	23	12	1
HPP22F-1517-17	15	+0.032/+0.102	17	23	17	1
HPP22F-1517-20	15	+0.032/+0.102	17	23	20	1
HPP22F-1618-09	16	+0.032/+0.102	18	24	9	1
HPP22F-1618-12	16	+0.032/+0.102	18	24	12	1
HPP22F-1618-17	16	+0.032/+0.102	18	24	17	1
HPP22F-1618-21	16	+0.032/+0.102	18	24	21	1
HPP22F-1719-09	17	+0.032/+0.102	19	25	9	1
HPP22F-1719-25	17	+0.032/+0.102	19	25	25	1
HPP22F-1820-04	18	+0.032/+0.102	20	26	4	1
HPP22F-1820-06	18	+0.032/+0.102	20	26	6	1
HPP22F-1820-11	18	+0.032/+0.102	20	26	11	1
HPP22F-1820-12	18	+0.032/+0.102	20	26	12	1
HPP22F-1820-17	18	+0.032/+0.102	20	26	17	1
HPP22F-1820-22	18	+0.032/+0.102	20	26	22	1
HPP22F-1820-30	18	+0.032/+0.102	20	26	30	1
HPP22F-2023-3.2	20	+0.04/+0.124	23	30	3.2	1.5
HPP22F-2023-07	20	+0.04/+0.124	23	30	7	1.5
HPP22F-2023-11.5	20	+0.04/+0.124	23	30	11.5	1.5
HPP22F-2023-16.5	20	+0.04/+0.124	23	30	16.5	1.5
HPP22F-2023-21.5	20	+0.04/+0.124	23	30	21.5	1.5
HPP22F-222535-09	22	+0.04/+0.124	25	35	9	1.5
HPP22F-2427-10	24	+0.04/+0.124	27	32	10	1.5
HPP22F-2528-11.5	25	+0.04/+0.124	28	35	11.5	1.5
HPP22F-2528-16.5	25	+0.04/+0.124	28	35	16.5	1.5
HPP22F-2528-21.5	25	+0.04/+0.124	28	35	21.5	1.5
HPP22F-2528-30	25	+0.04/+0.124	28	35	30	1.5
HPP22F-2830-36	28	+0.04/+0.124	30	35	36	2
HPP22F-3032-12	30	+0.04/+0.124	32	37	12	1
HPP22F-3034-16	30	+0.04/+0.124	34	42	16	2
HPP22F-3034-20	30	+0.04/+0.124	34	42	20	2
HPP22F-3034-26	30	+0.04/+0.124	34	42	26	2
HPP22F-3034-37	30	+0.04/+0.124	34	42	37	2
HPP22F-3034-45	30	+0.04/+0.124	34	42	45	2
HPP22F-3236-16	32	+0.05/+0.15	36	40	16	2

订购编码 Order PN	d ₁ [mm]	d ₁ - 公差 After fitting [mm]	d ₂ [mm]	d ₂ [d13] [mm]	L[h13] [mm]	t _{±0.15} [mm]
HPP22F-3236-26	32	+0.05/+0.15	36	40	26	2
HPP22F-3539-07	35	+0.05/+0.15	39	47	7	2
HPP22F-3539-12	35	+0.05/+0.15	39	47	12	2
HPP22F-3539-16	35	+0.05/+0.15	39	47	16	2
HPP22F-3539-26	35	+0.05/+0.15	39	47	26	2
HPP22F-3539-36	35	+0.05/+0.15	39	47	36	2
HPP22F-4044-14	40	+0.05/+0.15	44	52	14	2
HPP22F-4044-20	40	+0.05/+0.15	44	52	20	2
HPP22F-4044-30	40	+0.05/+0.15	44	52	30	2
HPP22F-4044-40	40	+0.05/+0.15	44	52	40	2
HPP22F-4044-50	40	+0.05/+0.15	44	52	50	2
HPP22F-4246-50	42	+0.05/+0.15	46	53	50	2
HPP22F-4550-30	45	+0.05/+0.15	50	58	30	2
HPP22F-4550-50	45	+0.05/+0.15	50	58	50	2

订购编码 Order PN	d ₁ [mm]	d ₁ - 公差 After fitting [mm]	d ₂ [mm]	d ₂ [d13] [mm]	L[h13] [mm]	t _{±0.15} [mm]
HPP22F-5055-10	50	+0.05/+0.15	55	63	10	2
HPP22F-5055-40	50	+0.05/+0.15	55	63	40	2
HPP22F-5055-50	50	+0.05/+0.15	55	63	50	2
HPP22F-6065-07	60	+0.06/+0.18	65	73	7	2
HPP22F-6065-22	60	+0.06/+0.18	65	73	22	2
HPP22F-6065-30	60	+0.06/+0.18	65	73	30	2
HPP22F-6065-50	60	+0.06/+0.18	65	73	50	2
HPP22F-6570-50	65	+0.06/+0.18	70	78	50	2
HPP22F-7075-50	70	+0.06/+0.18	75	83	50	2
HPP22F-9095-11	90	+0.072/+0.212	95	103	11	2.5
HPP22F-100105-11.5	100	+0.072/+0.212	105	113	11.5	2.5
HPP22F-100105-100	100	+0.072/+0.212	105	113	100	2.5

*d₁ 公差为压入标准 H7 座孔 (ISO3547-1) 后公差*Tolerance d₁: after being pressed into housing H7(ISO3547-1)

垫片 Metric Thrust Washers

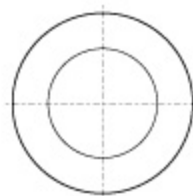

订购编码 Order PN:

HPP22 W-0509-006

材料 Material

垫片 Washer

d D T

订购编码 Order PN	d ^{+0.25} [mm]	D _{±0.25} [mm]	T _{±0.05} [mm]
HPP22W-0509-006	5	9	0.6
HPP22W-0615-015	6	15	1.5
HPP22W-0620-015	6	20	1.5
HPP22W-0815-005	8	15	0.5
HPP22W-0815-015	8	15	1.5
HPP22W-0818-010	8	18	1.0
HPP22W-0818-015	8	18	1.5
HPP22W-1018-010	10	18	1.0
HPP22W-1018-015	10	18	1.5
HPP22W-1018-020	10	18	2.0
HPP22W-1224-015	12	24	1.5
HPP22W-1426-015	14	26	1.5
HPP22W-1524-015	15	24	1.5
HPP22W-1630-015	16	30	1.5

订购编码 Order PN	d ^{+0.25} [mm]	D _{±0.25} [mm]	T _{±0.05} [mm]
HPP22W-1832-015	18	32	1.5
HPP22W-2036-015	20	36	1.5
HPP22W-2238-015	22	38	1.5
HPP22W-2442-015	24	42	1.5
HPP22W-2640-0075	26	40	0.75
HPP22W-2644-015	26	44	1.5
HPP22W-2848-015	28	48	1.5
HPP22W-3254-015	32	54	1.5
HPP22W-3862-015	38	62	1.5
HPP22W-4266-015	42	66	1.5
HPP22W-4874-020	48	74	2.0
HPP22W-5278-020	52	78	2.0
HPP22W-6290-020	62	90	2.0

* 根据要求提供定位孔设计 The fixing bore design upon request