

## HPP24-工程塑料轴承 Plastic Plain Bearings

### 轴承PV值 PV Value

HPP24塑料轴承最大运行PV值为 $0.5\text{N/mm}^2 \times \text{m/s}$ ;由此决定轴承所承受的载荷与速度成反比, 详细查阅图表HPP24-1。

The max PV value of the HPP31 plastic bearing is  $0.5\text{N/mm}^2 \times \text{m/s}$  which determines the load capacity of bearing is inversely proportional to the speed. Please refer to the chart for more detailed information (Graph HPP24-1).

图表 HPP24-1: PV 图表

Graph HPP24-1: Permissible PV value for HPP24

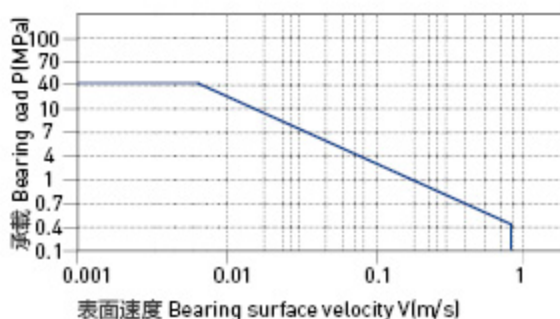

### 轴承的载荷、速度、温度 The Relation Of Load, Speed And Temperature

HPP24系列轴承可承受最大静载荷为45Mpa, 在此载荷下轴承的最大压缩变形量参考图表HPP24-2, 轴承实际工作载荷略小于45Mpa, 载荷还受到运行速度以及温度的影响, 速度越快(Vmax: 0.9m/s)会导致摩擦温度上升, 而温度上升(Tmax: 200℃)会导致轴承的承载能力逐渐减弱, 载荷随轴承工作温度变化情况参考图表HPP24-3。

HPP24 allows the Max static load of 45Mpa, The max compressive deformation rate under the max load is listed in Graph HPP24-1, The actual load capacity of bearing is slightly less than 45Mpa, The bearing load is variable against the speed and temperature, Fast speed (Vmax: 0.9m/s) results into higher temperature (Tmax: 200℃) which decreases the load capacity of the bearing. Please refer to the Graph HPP24-3 for such variation.

图表 HPP24-2: 载荷 - 温度 - 变形量图表

Graph HPP24-2: Load-Temperature deformation

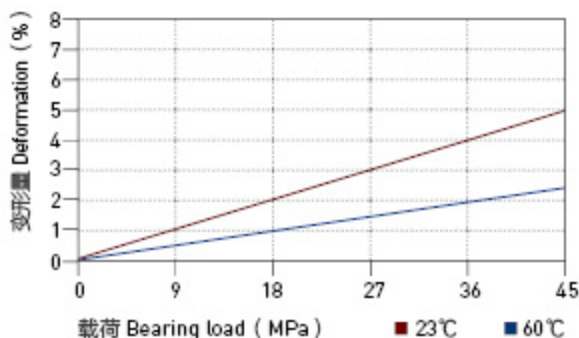

图表 HPP24-3: 载荷 - 温度图表

Graph HPP24-3: Load-Temperature diagrams

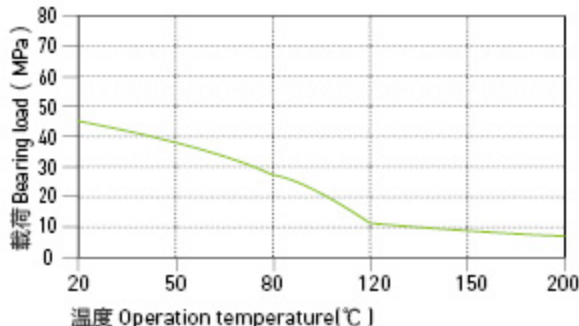

## HPP24-工程塑料轴承 Plastic Plain Bearings

### 轴承的摩擦系数、磨损、轴材料 Friction Factor, Wear And Shaft Material

#### ■ 轴承的摩擦系数 Friction factor

图表HPP24-4表明HPP24轴承的摩擦系数在载荷保持不变的情况下受运行速度的增加影响相对较小；图表HPP24-5表明HPP24轴承在保持速度不变的情况下，载荷从0增加到45Mpa过程中摩擦系数会逐步降低。图表HPP24-6表明HPP24轴承的摩擦系数会随着轴表面粗糙度的增大而逐渐升高，我们推荐合适的轴粗糙度为Ra0.1—0.6 $\mu$ m。

Graph HPP24-4 shows the friction factor of HPP24 is not obviously effected by the operation speed when the loading is stable and Graph HPP24-5 shows it will be decreasing along with the loading is increased from 0 to 45 Mpa when the operation speed is unchanged. The friction factor of HPP24 is increased along with the increasing of the shaft roughness. The recommended shaft roughness is Ra0.1 to Ra0.6.

HPP24	干运行 Dry	油脂 Grease	油 Oil	水 Water
摩擦系数 $\mu$ Friction coef.	0.05-0.20	0.09	0.04	0.04

#### ■ 磨损与轴材料 Wearing and shaft material

图表HPP24-7与图表HPP24-8表明HPP24轴承同时适合于硬质轴或软轴，在硬化钢轴和硬质阳极氧化轴上运行同样出色；但是硬化铝轴不适合用于HPP24轴承。图表HPP24-8表明HPP24轴承在做旋转运动下的磨损要略好于摆动运动下的磨损。

Graph HPP24-7 and Graph HPP24-8 tells that the HPP24 is very good for Hardened shaft and soft shaft and it features excellent both on hardened steel shaft and hardened shaft but the hardened aluminum shaft is not good for HPP24 bearings. Graph HPP24-8 shows that the wearing of HPP24 better on rottion operation than on oscillation operation.

图表 HPP24-4: 摩擦系数与速度变化关系图表 P=2MPa

Graph HPP24-4: Coefficient of friction & the speed of bearing, P=2MPa

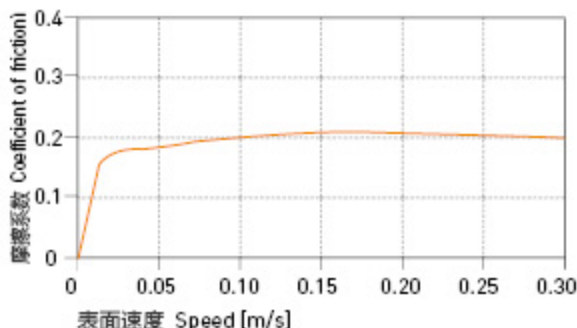

图表 HPP24-5: 摩擦系数与载荷变化关系图表 v=0.2m/s

Graph HPP24-5: Coefficient of friction & the pressure of bearing, v=0.2m/s

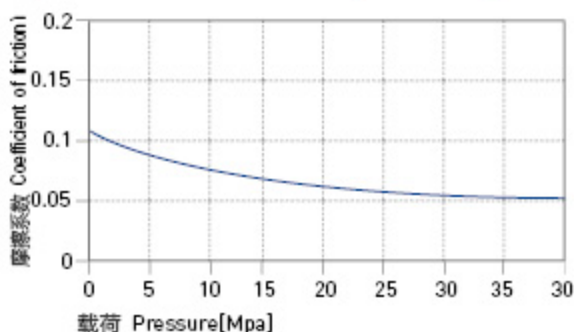

图表 HPP24-6: 摩擦系数与轴的表面粗糙度关系图表

Graph HPP24-6: Coefficient of friction & the surface roughness of shaft

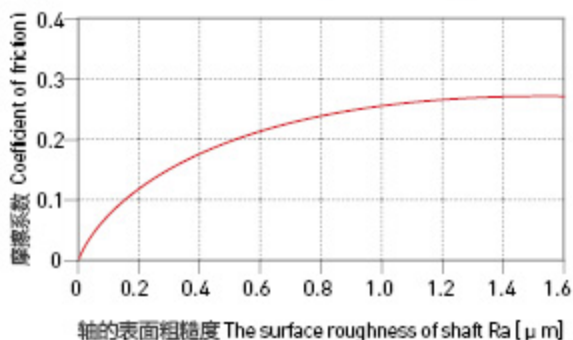

## HPP24-工程塑料轴承 Plastic Plain Bearings

### 轴承的摩擦系数、磨损、轴材料 Friction Factor, Wear And Shaft Material

#### ■ 化学抗性 Chemical Resistance

HPP24塑料轴承具有很好的化学抗性，能抵抗绝大多数酸碱。

The Chemical Resistance of HPP24 is fairly good against most of Acid and Alkalis.

#### ■ 吸水性 Water Absorbability

在标准大气压中，HPP24塑料轴承的吸水率极低小于0.1%，浸泡水中最大平衡吸水率小于0.1%；因此材料不会吸水而发生性能和尺寸变化，适用于潮湿环境甚至水下。

The water absorb rate of HPP24 is less than 0.1% under the atmospheric pressure while it is less than 0.1% when the material is immersed into water. The material performance and dimensions of the material is stabilized for the applications under humid environment or evenjn the water.

#### ■ 抗UV性能 UV Resistance

HPP24长久暴露在紫外线下材料表面会发生蜕变，抗压强度会下降。

Disintegration could be possible for the material HPP24 after long period of exposing under the UV ray and therefore the compressive strength will be reduced.

#### ■ 安装公差 Installation Tolerances

HPP24塑料轴承压装后公差Tolerances after pressfit

直径 Di. [ mm ]	HPP24 E10 [ mm ]	座孔 Housing H7 [ mm ]	轴 Shaft h9 [ mm ]
> 0-3	+0.006~+0.046	0~+0.010	0~-0.025
> 3-6	+0.010~+0.058	0~+0.012	0~-0.030
> 6-10	+0.013~+0.071	0~+0.015	0~-0.036
> 10-18	+0.016~+0.086	0~+0.018	0~-0.043
> 18-30	+0.020~+0.104	0~+0.021	0~-0.052
> 30-50	+0.025~+0.125	0~+0.025	0~-0.062
> 50-80	+0.030~+0.150	0~+0.030	0~-0.074

图表 HPP24-7: 在不同轴材料上旋转时的磨损量  $P=2MPa$ ,  $v=0.2m/s$   
 Graph HPP24-7: The bearing wear under rotating with different shaft materials,  $p=2MPa$ ,  $v=0.2m/s$

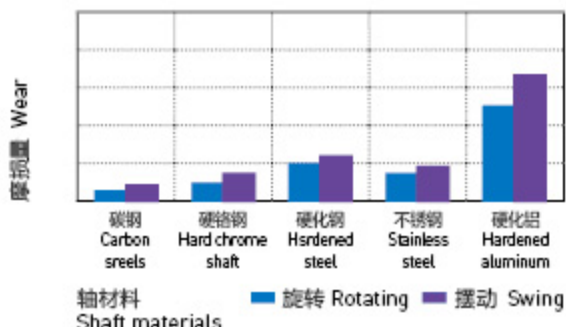

图表 HPP24-8: 旋转磨损随轴材料与压力变化关系  $v=0.2m/s$   
 Graph HPP24-8: The bearing wear & pressure under rotating with different shaft materials,  $v=0.2m/s$

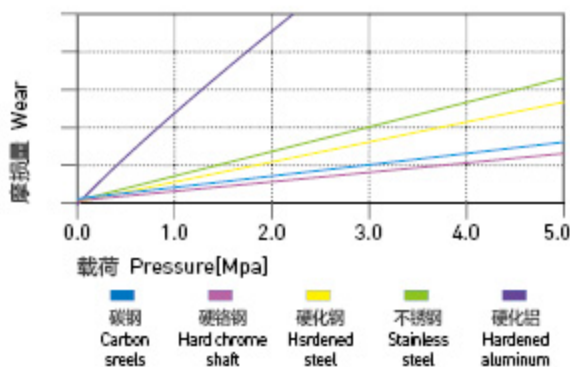

图表 HPP24-9: 吸水性的影响  
 Graph HPP24-9: Effect of moisture absorption on HPP24 bearings

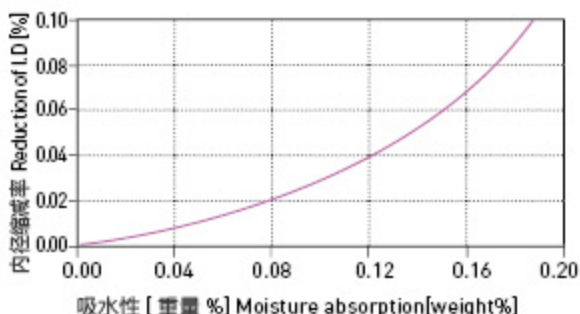



## HPP24标准规格Standard 直套Metric Cylindrical Bushings

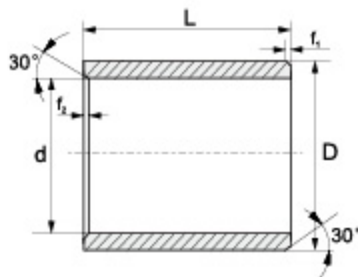

推荐安装公差 Recommend fitting tolerance:

座孔 Housing: H7

轴 Shaft: h9

订购编码 Order P/N:

HPP24-0203-03

材料 Material

d	f <sub>1</sub>	f <sub>2</sub>
1-6	0.3	0.5
6-12	0.5	
12-30	0.8	
>30	1.2	

订购编码 Order PN	d [mm]	d-公差 After fitting [mm]	D [mm]	L[h13] [mm]
HPP24-0203-03	2	+0.014/+0.054	3.5	3
HPP24-0304-03	3	+0.014/+0.054	4.5	3
HPP24-0304-05	3	+0.014/+0.054	4.5	5
HPP24-0304-06	3	+0.014/+0.054	4.5	6
HPP24-0405-04	4	+0.02/+0.068	5.5	4
HPP24-0405-06	4	+0.02/+0.068	5.5	6
HPP24-0506-05S	5	+0.01/+0.04	6	5
HPP24-0507-05	5	+0.02/+0.068	7	5
HPP24-0507-08	5	+0.02/+0.068	7	8
HPP24-0507-10	5	+0.02/+0.068	7	10
HPP24-0608-04	6	+0.02/+0.068	8	4
HPP24-0608-05	6	+0.02/+0.068	8	5
HPP24-0608-06	6	+0.02/+0.068	8	6
HPP24-0608-08	6	+0.02/+0.068	8	8
HPP24-0608-09	6	+0.02/+0.068	8	9
HPP24-0608-10	6	+0.02/+0.068	8	10
HPP24-0608-11	6	+0.02/+0.068	8	11
HPP24-0810-05	8	+0.025/+0.083	10	5
HPP24-0810-06	8	+0.025/+0.083	10	6
HPP24-0810-07	8	+0.025/+0.083	10	7
HPP24-0810-08	8	+0.025/+0.083	10	8
HPP24-0810-10	8	+0.025/+0.083	10	10
HPP24-0810-12	8	+0.025/+0.083	10	12
HPP24-0810-13	8	+0.025/+0.083	10	13
HPP24-0810-15	8	+0.025/+0.083	10	15
HPP24-0810-21	8	+0.025/+0.083	10	21
HPP24-1011-06	10	+0.025/+0.083	11	6
HPP24-1012-04	10	+0.025/+0.083	12	4
HPP24-1012-05	10	+0.025/+0.083	12	5
HPP24-1012-06	10	+0.025/+0.083	12	6
HPP24-1012-07	10	+0.025/+0.083	12	7
HPP24-1012-08	10	+0.025/+0.083	12	8
HPP24-1012-09	10	+0.025/+0.083	12	9
HPP24-1012-10	10	+0.025/+0.083	12	10
HPP24-1012-12	10	+0.025/+0.083	12	12
HPP24-1012-14	10	+0.025/+0.083	12	14

订购编码 Order PN	d [mm]	d-公差 After fitting [mm]	D [mm]	L[h13] [mm]
HPP24-1012-15	10	+0.025/+0.083	12	15
HPP24-1012-17	10	+0.025/+0.083	12	17
HPP24-1012-20	10	+0.025/+0.083	12	20
HPP24-1213-12S	12	+0.016/+0.059	13	12
HPP24-1214-04	12	+0.032/+0.102	14	4
HPP24-1214-06	12	+0.032/+0.102	14	6
HPP24-1214-08	12	+0.032/+0.102	14	8
HPP24-1214-10	12	+0.032/+0.102	14	10
HPP24-1214-12	12	+0.032/+0.102	14	12
HPP24-1214-14	12	+0.032/+0.102	14	14
HPP24-1214-15	12	+0.032/+0.102	14	15
HPP24-1214-20	12	+0.032/+0.102	14	20
HPP24-1214-25	12	+0.032/+0.102	14	25
HPP24-1315-15	13	+0.032/+0.102	15	15
HPP24-1315-25	13	+0.032/+0.102	15	25
HPP24-1416-03	14	+0.032/+0.102	16	3
HPP24-1416-08	14	+0.032/+0.102	16	8
HPP24-1416-10	14	+0.032/+0.102	16	10
HPP24-1416-15	14	+0.032/+0.102	16	15
HPP24-1416-20	14	+0.032/+0.102	16	20
HPP24-1416-25	14	+0.032/+0.102	16	25
HPP24-1517-10	15	+0.032/+0.102	17	10
HPP24-1517-12	15	+0.032/+0.102	17	12
HPP24-1517-15	15	+0.032/+0.102	17	15
HPP24-1517-20	15	+0.032/+0.102	17	20
HPP24-1517-25	15	+0.032/+0.102	17	25
HPP24-1618-10	16	+0.032/+0.102	18	10
HPP24-1618-12	16	+0.032/+0.102	18	12
HPP24-1618-15	16	+0.032/+0.102	18	is
HPP24-1618-20	16	+0.032/+0.102	18	20
HPP24-1618-25	16	+0.032/+0.102	18	25
HPP24-1618-30	16	+0.032/+0.102	18	30
HPP24-1820-10	18	+0.032/+0.102	20	10
HPP24-1820-12	18	+0.032/+0.102	20	12
HPP24-1820-15	18	+0.032/+0.102	20	15
HPP24-1820-20	18	+0.0321/+0.102	20	20

订购编码 Order PN	d [mm]	d- 公差 After fitting [mm]	D [mm]	L(h13) [mm]
HPP24-1820-25	18	+0.032/+0.102	20	25
HPP24-2022-20	20	+0.04/+0.124	22	20
HPP24-2022-30	20	+0.04/+0.124	22	30
HPP24-2023-10	20	+0.04/+0.124	23	10
HPP24-2023-15	20	+0.04/+0.124	23	15
HPP24-2023-20	20	+0.04/+0.124	23	20
HPP24-2023-25	20	+0.04/+0.124	23	25
HPP24-2023-30	20	+0.04/+0.124	23	30
HPP24-2225-15	22	+0.04/+0.124	25	15
HPP24-2225-20	22	+0.04/+0.124	25	20
HPP24-2225-25	22	+0.04/+0.124	25	25
HPP24-2225-30	22	+0.04/+0.124	25	30
HPP24-2528-12	25	+0.04/+0.124	28	12
HPP24-2528-15	25	+0.04/+0.124	28	15
HPP24-2528-20	25	+0.04/+0.124	28	20
HPP24-2528-24	25	+0.04/+0.124	28	24
HPP24-2528-25	25	+0.04/+0.124	28	25
HPP24-2528-30	25	+0.04/+0.124	28	30
HPP24-2528-35	25	+0.04/+0.124	28	35
HPP24-2832-30	28	+0.04/+0.124	32	30
HPP24-3034-15	30	+0.04/+0.124	34	15
HPP24-3034-20	30	+0.04/+0.124	34	20
HPP24-3034-24	30	+0.04/+0.124	34	24
HPP24-3034-25	30	+0.04/+0.124	34	25
HPP24-3034-30	30	+0.04/+0.124	34	30
HPP24-3034-35	30	+0.04/+0.124	34	35
HPP24-3034-40	30	+0.04/+0.124	34	40
HPP24-3236-30	32	+0.05/+0.15	36	30
HPP24-3236-40	32	+0.05/+0.15	36	40
HPP24-3539-14	35	+0.05/+0.15	39	14
HPP24-3539-20	35	+0.05/+0.15	39	20
HPP24-3539-25	35	+0.05/+0.15	39	25
HPP24-3539-30	35	+0.05/+0.15	39	30

订购编码 Order PN	d [mm]	d- 公差 After fitting [mm]	D [mm]	L(h13) [mm]
HPP24-3539-40	35	+0.05/+0.15	39	40
HPP24-3539-50	35	+0.05/+0.15	39	50
HPP24-3640-20	36	+0.05/+0.15	40	20
HPP24-4044-10	40	+0.05/+0.15	44	10
HPP24-4044-16	40	+0.05/+0.15	44	16
HPP24-4044-20	40	+0.05/+0.15	44	20
HPP24-4044-30	40	+0.05/+0.15	44	30
HPP24-4044-40	40	+0.05/+0.15	44	40
HPP24-4044-50	40	+0.05/+0.15	44	50
HPP24-4246-40	42	+0.05/+0.15	46	40
HPP24-4246-50	42	+0.05/+0.15	46	50
HPP24-4550-40	45	+0.05/+0.15	50	40
HPP24-4550-50	45	+0.05/+0.15	50	50
HPP24-5055-20	50	+0.05/+0.15	55	20
HPP24-5055-30	50	+0.05/+0.15	55	30
HPP24-5055-40	50	+0.05/+0.15	55	40
HPP24-5055-50	50	+0.05/+0.15	55	50
HPP24-5560-20	55	+0.06/+0.18	60	20
HPP24-5560-26	55	+0.06/+0.18	60	26
HPP24-5560-40	55	+0.06/+0.18	60	40
HPP24-5560-50	55	+0.06/+0.18	60	50
HPP24-5560-60	55	+0.06/+0.18	60	60
HPP24-6065-30	60	+0.06/+0.18	65	30
HPP24-6065-40	60	+0.06/+0.18	65	40
HPP24-6065-50	60	+0.06/+0.18	65	50
HPP24-6065-60	60	+0.06/+0.18	65	60
HPP24-6570-50	65	+0.06/+0.18	70	50
HPP24-7075-60	70	+0.06/+0.18	75	60
HPP24-7580-40	75	+0.06/+0.18	80	40
HPP24-115121-90	115	+0.072/+0.212	121	90
HPP24-120125-100	120	+0.072/+0.212	125	100

\*d 公差为压入标准 H7 座孔 (ISO3547-1) 后公差

\*Tolerance d: after being pressed into housing H7(ISO3547-1)

## 翻边轴套 Metric Flange Bushings

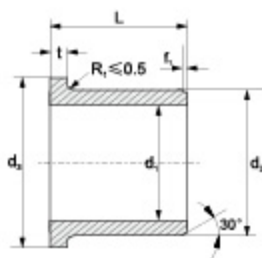

推荐安装公差 Recommend fitting tolerance:

座孔 Housing: H7

轴 Shaft: h9

订购编码 Order P/N:

HPP24 F-0304-03

材料 Material  
 翻边轴套 Flange bushes

d	f
1-6	0.3
6-12	0.5
12-30	0.8
>30	1.2

订购编码 Order PN	d <sub>1</sub> [mm]	d <sub>1</sub> -公差 After fitting [mm]	d <sub>2</sub> [mm]	d <sub>2</sub> [d13] [mm]	L[h13] [mm]	t <sub>0.16</sub> [mm]
HPP24F-0304-03	3	+0.014/+0.054	4.5	7.5	3	0.75
HPP24F-0304-05	3	+0.014/+0.054	4.5	7.5	5	0.75
HPP24F-0405-03	4	+0.02/+0.068	5.5	9.5	3	0.75
HPP24F-0405-04	4	+0.02/+0.068	5.5	9.5	4	0.75
HPP24F-0405-06	4	+0.02/+0.068	5.5	9.5	6	0.75
HPP24F-0506-3.5S	5	+0.01/+0.04	6	10	3.5	0.5
HPP24F-0506-05S	5	+0.01/+0.04	6	10	5	0.5
HPP24F-050614-06S	5	+0.01/+0.04	6	14	6	0.5
HPP24F-0507-03	5	+0.02/+0.068	7	11	3	1
HPP24F-0507-04	5	+0.02/+0.068	7	11	4	1
HPP24F-0507-05	5	+0.02/+0.068	7	11	5	1
HPP24F-0507-07	5	+0.02/+0.068	7	11	7	1
HPP24F-0607-10	6	+0.01/+0.04	7	11	10	0.5
HPP24F-0608-04	6	+0.02/+0.068	8	12	4	1
HPP24F-0608-05	6	+0.02/+0.068	8	12	5	1
HPP24F-0608-06	6	+0.02/+0.068	8	12	6	1
HPP24F-0608-07	6	+0.02/+0.068	8	12	7	1
HPP24F-0608-08	6	+0.02/+0.068	8	12	8	1
HPP24F-0608-10	6	+0.02/+0.068	8	12	10	1
HPP24F-0708-08S	7	+0.013/+0.049	8	12	8	0.5
HPP24F-0809-12	8	+0.013/+0.049	9	13	12	0.5
HPP24F-0810-04	8	+0.025/+0.083	10	15	4	1
HPP24F-0810-05	8	+0.025/+0.083	10	15	5	1
HPP24F-0810-07	8	+0.025/+0.083	10	15	7	1
HPP24F-0810-09	8	+0.025/+0.083	10	15	9	1
HPP24F-0810-10	8	+0.025/+0.083	10	15	10	1
HPP24F-0810-15	8	+0.025/+0.083	10	15	15	1
HPP24F-0810-30	8	+0.025/+0.083	10	15	30	1
HPP24F-1012-04	10	+0.025/+0.083	12	18	4	1
HPP24F-1012-05	10	+0.025/+0.083	12	18	5	1
HPP24F-1012-06	10	+0.025/+0.083	12	18	6	1
HPP24F-1012-07	10	+0.025/+0.083	12	18	7	1
HPP24F-1012-09	10	+0.025/+0.083	12	18	9	1
HPP24F-1012-10	10	+0.025/+0.083	12	18	10	1
HPP24F-1012-12	10	+0.025/+0.083	12	18	12	1
HPP24F-1012-15	10	+0.025/+0.083	12	18	15	1
HPP24F-1012-17	10	+0.025/+0.083	12	18	17	1
HPP24F-101216-06	10	+0.025/+0.083	12	16	6	1
HPP24F-101216-09	10	+0.025/+0.083	12	16	9	1
HPP24F-1213-12S	12	+0.016/+0.059	13	17	12	0.5
HPP24F-1214-06	12	+0.032/+0.102	14	20	6	1
HPP24F-1214-07	12	+0.032/+0.102	14	20	7	1
HPP24F-1214-09	12	+0.032/+0.102	14	20	9	1
HPP24F-1214-10	12	+0.032/+0.102	14	20	10	1
HPP24F-1214-11	12	+0.032/+0.102	14	20	11	1
HPP24F-1214-12	12	+0.032/+0.102	14	20	12	1
HPP24F-1214-15	12	+0.032/+0.102	14	20	15	1

订购编码 Order PN	d <sub>1</sub> [mm]	d <sub>1</sub> -公差 After fitting [mm]	d <sub>2</sub> [mm]	d <sub>2</sub> [d13] [mm]	L[h13] [mm]	t <sub>0.16</sub> [mm]
HPP24F-1214-17	12	+0.032/+0.102	14	20	17	1
HPP24F-1214-20	12	+0.032/+0.102	14	20	20	1
HPP24F-1214-24	12	+0.032/+0.102	14	20	24	1
HPP24F-1416-03	14	+0.032/+0.102	16	22	3	1
HPP24F-1416-04	14	+0.032/+0.102	16	22	4	1
HPP24F-1416-06	14	+0.032/+0.102	16	22	6	1
HPP24F-1416-08	14	+0.032/+0.102	16	22	8	1
HPP24F-1416-12	14	+0.032/+0.102	16	22	12	1
HPP24F-1416-17	14	+0.032/+0.102	16	22	17	1
HPP24F-1416-21	14	+0.032/+0.102	16	22	21	1
HPP24F-1517-05	15	+0.032/+0.102	17	23	5	1
HPP24F-1517-09	15	+0.032/+0.102	17	23	9	1
HPP24F-1517-12	15	+0.032/+0.102	17	23	12	1
HPP24F-1517-17	15	+0.032/+0.102	17	23	17	1
HPP24F-1517-20	15	+0.032/+0.102	17	23	20	1
HPP24F-1618-09	16	+0.032/+0.102	18	24	9	1
HPP24F-1618-12	16	+0.032/+0.102	18	24	12	1
HPP24F-1618-17	16	+0.032/+0.102	18	24	17	1
HPP24F-1618-21	16	+0.032/+0.102	18	24	21	1
HPP24F-1719-09	17	+0.032/+0.102	19	25	9	1
HPP24F-1719-25	17	+0.032/+0.102	19	25	25	1
HPP24F-1820-04	18	+0.032/+0.102	20	26	4	1
HPP24F-1820-06	18	+0.032/+0.102	20	26	6	1
HPP24F-1820-11	18	+0.032/+0.102	20	26	11	1
HPP24F-1820-12	18	+0.032/+0.102	20	26	12	1
HPP24F-1820-17	18	+0.032/+0.102	20	26	17	1
HPP24F-1820-22	18	+0.032/+0.102	20	26	22	1
HPP24F-1820-30	18	+0.032/+0.102	20	26	30	1
HPP24F-2023-3.2	20	+0.04/+0.124	23	30	3.2	1.5
HPP24F-2023-07	20	+0.04/+0.124	23	30	7	1.5
HPP24F-2023-11.5	20	+0.04/+0.124	23	30	11.5	1.5
HPP24F-2023-16.5	20	+0.04/+0.124	23	30	16.5	1.5
HPP24F-2023-21.5	20	+0.04/+0.124	23	30	21.5	1.5
HPP24F-222535-09	22	+0.04/+0.124	25	35	9	1.5
HPP24F-2427-10	24	+0.04/+0.124	27	32	10	1.5
HPP24F-2528-11.5	25	+0.04/+0.124	28	35	11.5	1.5
HPP24F-2528-16.5	25	+0.04/+0.124	28	35	16.5	1.5
HPP24F-2528-21.5	25	+0.04/+0.124	28	35	21.5	1.5
HPP24F-2528-30	25	+0.04/+0.124	28	35	30	1.5
HPP24F-2830-36	28	+0.04/+0.124	30	35	36	2
HPP24F-3032-12	30	+0.04/+0.124	32	37	12	1
HPP24F-3034-16	30	+0.04/+0.124	34	42	16	2
HPP24F-3034-20	30	+0.04/+0.124	34	42	20	2
HPP24F-3034-26	30	+0.04/+0.124	34	42	26	2
HPP24F-3034-37	30	+0.04/+0.124	34	42	37	2
HPP24F-3034-45	30	+0.04/+0.124	34	42	45	2
HPP24F-3236-16	32	+0.05/+0.15	36	40	16	2



订购编码 Order PN	d <sub>1</sub> [mm]	d <sub>1</sub> - 公差 After fitting [mm]	d <sub>2</sub> [mm]	d <sub>2</sub> [d13] [mm]	L[h13] [mm]	t <sub>0.16</sub> [mm]
HPP24F-3236-26	32	+0.05/+0.15	36	40	26	2
HPP24F-3539-07	35	+0.05/+0.15	39	47	7	2
HPP24F-3539-12	35	+0.05/+0.15	39	47	12	2
HPP24F-3539-16	35	+0.05/+0.15	39	47	16	2
HPP24F-3539-26	35	+0.05/+0.15	39	47	26	2
HPP24F-3539-36	35	+0.05/+0.15	39	47	36	2
HPP24F-4044-14	40	+0.05/+0.15	44	52	14	2
HPP24F-4044-20	40	+0.05/+0.15	44	52	20	2
HPP24F-4044-30	40	+0.05/+0.15	44	52	30	2
HPP24F-4044-40	40	+0.05/+0.15	44	52	40	2
HPP24F-4044-50	40	+0.05/+0.15	44	52	50	2
HPP24F-4246-50	42	+0.05/+0.15	46	53	50	2
HPP24F-4550-30	45	+0.05/+0.15	50	58	30	2
HPP24F-4550-50	45	+0.05/+0.15	50	58	50	2

订购编码 Order PN	d <sub>1</sub> [mm]	d <sub>1</sub> - 公差 After fitting [mm]	d <sub>2</sub> [mm]	d <sub>2</sub> [d13] [mm]	L[h13] [mm]	t <sub>0.16</sub> [mm]
HPP24F-5055-10	50	+0.05/+0.15	55	63	10	2
HPP24F-5055-40	50	+0.05/+0.15	55	63	40	2
HPP24F-5055-50	50	+0.05/+0.15	55	63	50	2
HPP24F-6065-07	60	+0.06/+0.18	65	73	7	2
HPP24F-6065-22	60	+0.06/+0.18	65	73	22	2
HPP24F-6065-30	60	+0.06/+0.18	65	73	30	2
HPP24F-6065-50	60	+0.06/+0.18	65	73	50	2
HPP24F-6570-50	65	+0.06/+0.18	70	78	50	2
HPP24F-7075-50	70	+0.06/+0.18	75	83	50	2
HPP24F-9095-11	90	+0.072/+0.212	95	103	11	2.5
HPP24F-100105-11.5	100	+0.072/+0.212	105	113	11.5	2.5
HPP24F-100105-100	100	+0.072/+0.212	105	113	100	2.5

\*d<sub>1</sub> 公差为压入标准 H7 座孔 (ISO3547-1) 后公差\*Tolerance d<sub>1</sub>: after being pressed into housing H7(ISO3547-1)

## 垫片 Metric Thrust Washers

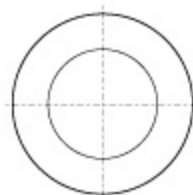

订购编码 Order PN:

HPP24 W-0509-006

HPP24 W-0509-006  
 | | | | |  
 d D T  
 垫片 Washer  
 材料 Material

订购编码 Order PN	d <sup>+0.25</sup> [mm]	D <sub>0.25</sub> [mm]	T <sub>±0.05</sub> [mm]
HPP24W-0509-006	5	9	0.6
HPP24W-0615-015	6	15	1.5
HPP24W-0620-015	6	20	1.5
HPP24W-0815-005	8	15	0.5
HPP24W-0815-015	8	15	1.5
HPP24W-0818-010	8	18	1.0
HPP24W-0818-015	8	18	1.5
HPP24W-1018-010	10	18	1.0
HPP24W-1018-015	10	18	1.5
HPP24W-1018-020	10	18	2.0
HPP24W-1224-015	12	24	1.5
HPP24W-1426-015	14	26	1.5
HPP24W-1524-015	15	24	1.5
HPP24W-1630-015	16	30	1.5

订购编码 Order PN	d <sup>+0.25</sup> [mm]	D <sub>0.25</sub> [mm]	T <sub>±0.05</sub> [mm]
HPP24W-1832-015	18	32	1.5
HPP24W-2036-015	20	36	1.5
HPP24W-2238-015	22	38	1.5
HPP24W-2442-015	24	42	1.5
HPP24W-2640-0075	26	40	0.75
HPP24W-2644-015	26	44	1.5
HPP24W-2848-015	28	48	1.5
HPP24W-3254-015	32	54	1.5
HPP24W-3862-015	38	62	1.5
HPP24W-4266-015	42	66	1.5
HPP24W-4874-020	48	74	2.0
HPP24W-5278-020	52	78	2.0
HPP24W-6290-020	62	90	2.0

\* 根据要求提供定位孔设计 The fixing bore design upon request